

WHERE INSPIRATION REIGNS

The mountains are conducive to clear thinking and deep discussions. In the captivating landscape, our hotel offers everything that's important for a meeting: quiet, space and light, amazing cuisine and very attentive service. Central but absolutely peaceful accommodation: slightly above the village of Adelboden and surrounded by a pleasant garden. In every direction there are views of the mountains and the sky above.

As a small, elegant hotel specialising in equally small but discerning conferences, we offer the ideal setting for your inspiring moments. We look forward to hosting you.

Denise Mani and Daniel Schüpfer, your hosts

INFRASTRUCTURE

Here, generously proportioned, airy architecture is combined with a vibrant hotel culture. Our spaces fulfil the highest requirements for comfort.

Conference rooms

- Conference room Espace, 93 m²
- Conference room Sommet, 47 m²
- Group rooms, 18 to 22 m²

Rooms

- 36 double and single rooms and 14 suits

Restaurants

- Restaurant «Belle Vue» with 70 seats
- Restaurant «La Salle» with 40 seats
- Bar and Lounge

Spa «pour»

- Indoor pool (29 °C, 16×8 m)
- Outdoor saltwater pool (35 °C, 9×5 m)
- Eucalyptus Steam Bath (48 °C) and Floral Steam Bath (40 °C)
- Himalayan Salt Sauna (70 °C)
- External sauna (85 °C) and Biosauna (60 °C)
- Cardio and fitness room

Park

- Garden with sun desk

CONFERENCE ROOM SPACE

This room was renovated in 2013. It is light-filled and impressive for its elegance and panoramic view.

Ground floor, south-eastern exposure,
93 m², 10.7 m × 8.7 m, 2.6 m ceiling height

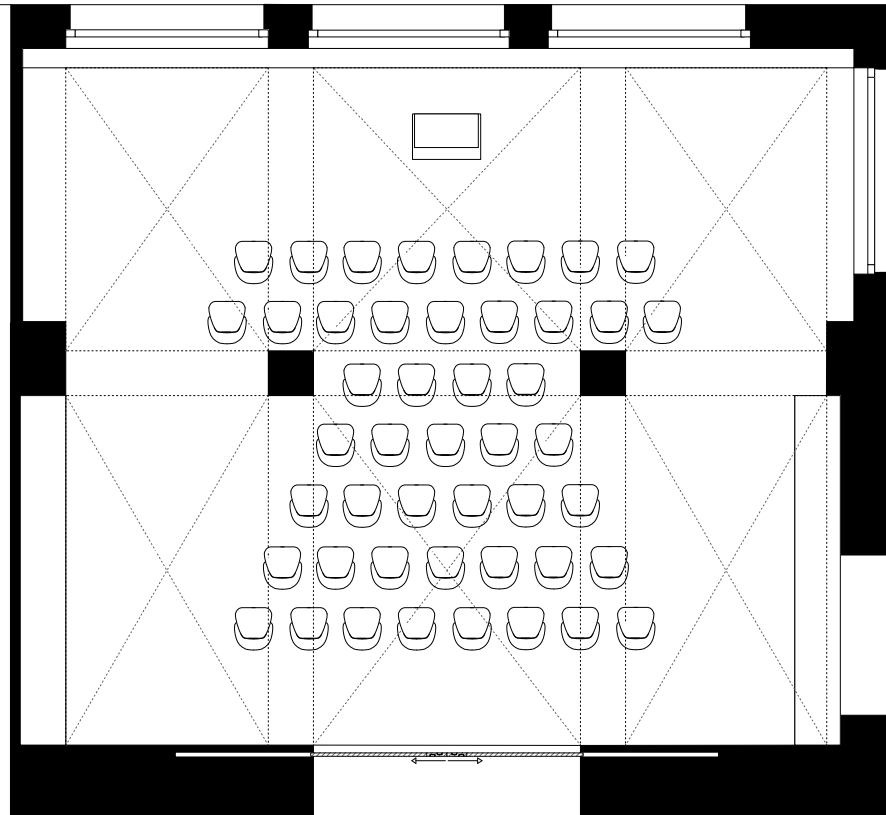

Group rooms for 6 to 7 persons,
Southeast and Southwest, 18 to 22 m²

SEATING ESPCACE

Seating		Max. number of persons
U-Shape		18
Boardroom		30
Seminar		24
Concert		60

CONFERENCE ROOM SOMMET

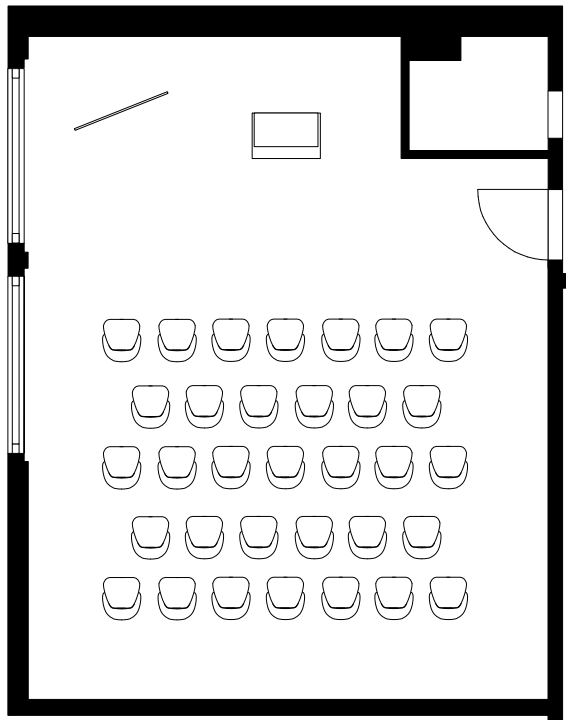

This light-filled conference room was entirely renovated in 2012. It is distinguished by its comfort, quiet and spaciousness.

Fourth floor, north-eastern exposure,
47 m², 6.1 m × 7.7 m, 3.3 m ceiling height

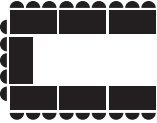

Group rooms for 6 to 7 persons,
Southeast and Southwest, 18–22 m²

SEATING SOMMET

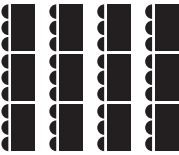
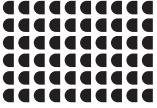
Seating		Max. number of persons
U-Shape		14
Boardroom		16
Seminar		12
Concert		30

FLAT RATE COMFORT

The seminar rate with great service:

- One overnight stay in a single-occupancy double room with buffet breakfast
- Use of meeting rooms
- Use of projector, overhead projector, notice board and flipcharts
- Two-course business lunch
- Dinner, five-course market menu
- Two «vitalité & énergie» coffee breaks
- Mineral water in the meeting room
- Free entry into the Spa «pour» (1700 m²)
- Wi-Fi access

Winter season

per person in CHF

Mid-December to mid-April **325**

Summer season

Mid-May to mid-December **280**

inkl. VAT

FLAT RATE ECONOMY

The streamlined package with a business lunch, dinner and one coffee break:

- One overnight stay in a North-facing single room with buffet breakfast
- Use of meeting rooms
- Use of projector, overhead projector, notice board and flipcharts
- Two-course business lunch
- Dinner, three-course market menu
- One coffee break
- Adalboden spring water in the meeting room
- Free entry into the Spa «pour» (1700 m²)
- Wi-Fi access

Winter season

per person in CHF

Mid-December to mid-April **280**

Summer season

Mid-May to mid-December **235**

inkl. VAT

DAILY FLAT RATE

Enjoy the Bellevue service – even without an overnight stay:

- Use of meeting rooms
- Use of projector, overhead projector, notice board and flipcharts
- Three-course business lunch and two coffee breaks
- Mineral water in the meeting room
- Wi-Fi access

per person incl. VAT

Daily flat rate	90
-----------------	----

STAND-ALONE SERVICES

So you can tailor your event to your needs.

Catering	CHF
2-course / 3-course business lunch	32 / 45
4-course / 3-course dinner “Menu marché”	65 / 75
Coffee break	9
“Vitalité & Energie” coffee break	12

Technical items	Lease per day in CHF
Beamer*	120
Overhead projector*	50
Bulletin board*	20
Flipchart*	20
Facilitator’s toolbox	20
Lectern on wheels	95
LCD TV up to 42”	150
LCD TV up to 55”	230
Live webcast, 1/2 day	780
Live webcast	1250
Other accessories upon request	

* 1 beamer, 1 overhead projector, 2 bulletin boards and 2 flipcharts are included in the Economy, Comfort and daily conference packages.

FRAMEWORK PROGRAMM

Experience the Alps up close. An attractive framework programme can be a significant contribution to the success of your conference.

Our recommendations:

- Wine tasting or aperitif in the wine cellar
- Fondue evening in the Bergrestaurant or igloo
- Visit to an alpine herdsman's hut
- Alpine Olympiad
- Group summit experience
- Snowshoeing
- First steps on the curling ice
- Bowling at the leisure and sports arena

Let us know your requests and ideas. We would be happy to put together a tailored programme.